

CREATIVE CUSTOMER CARE CENTRE

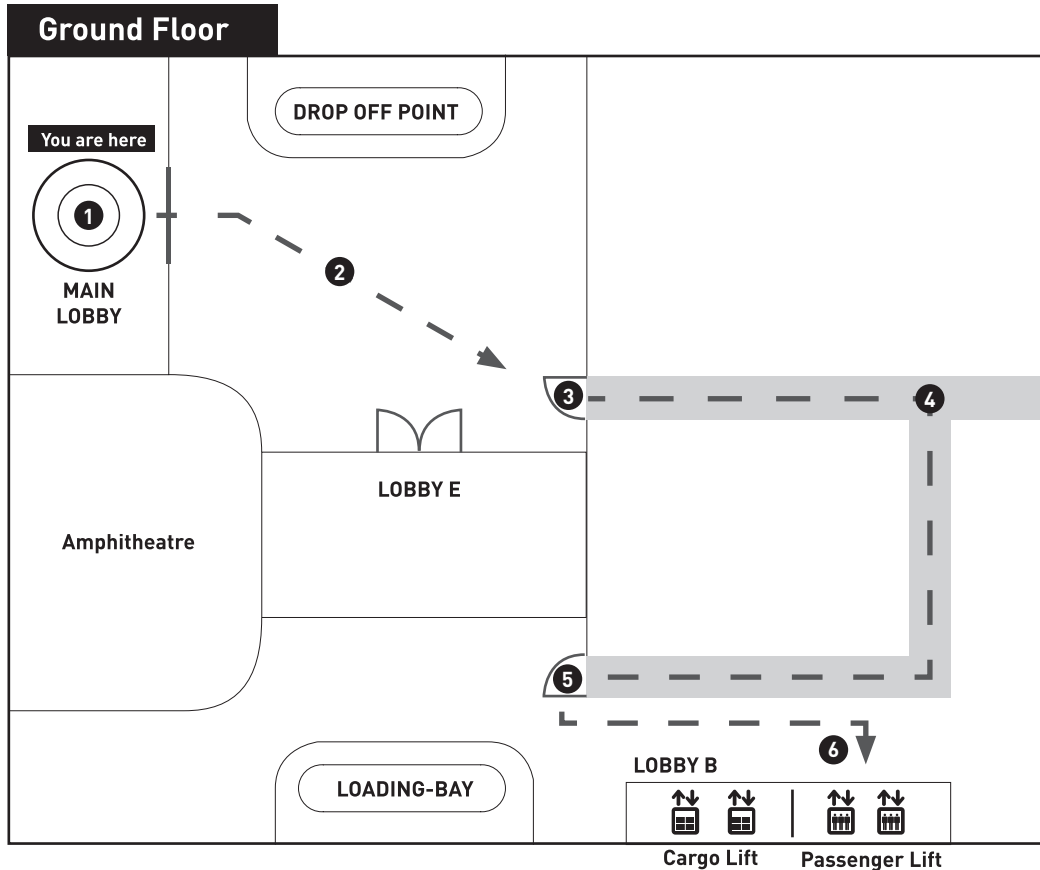

Ground Floor

- 1 From main lobby, exit and **turn slight right**.
- 2 Walk towards **door leading to LOADING BAY**. (Sheltered Area)
- 3 Take the door on the **left and enter walk-way**.
- 4 On first junction, **turn right** and proceed all the way till you reach the end of walk-way.
- 5 Exit from the door and turn towards the left where you will approach **LOBBY B**
- 6 Use Passenger lifts and proceed to the **4th Level**.

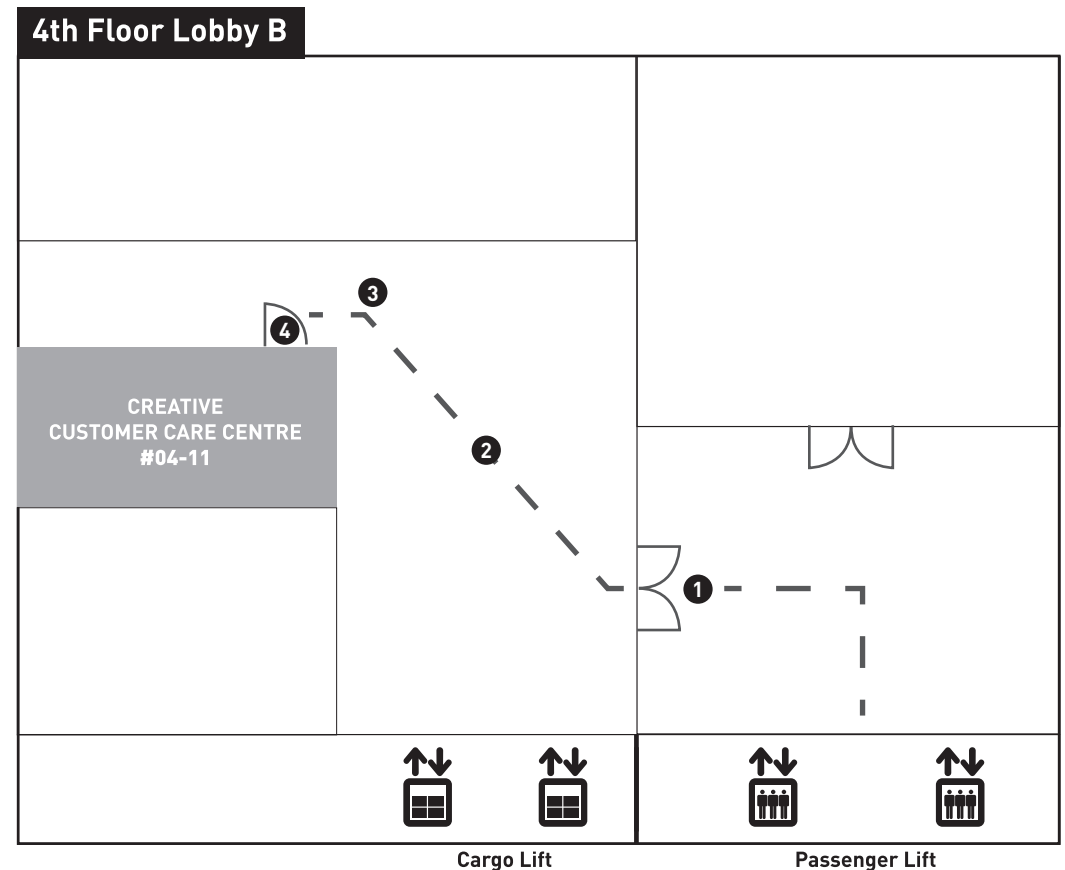

At 4th Floor Lobby B(Creative Customer Care #04-11)

- 1 After exiting on **4th floor**, proceed through the door on your left.
- 2 Walk towards the walk-way on the right. (There should be a signage)
- 3 Entrance of the Creative Customer Care will be on your left. Unit **#04-11**
- 4 Enter through glass door.